

Alarm Keypad 2

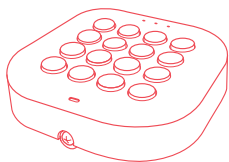

INSTALLATION MANUAL

KEPZB-122

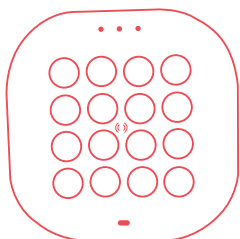

Product description

The Alarm Keypad 2 includes a tag reader and allows you to enable and disable an alarm system. The keypad detects when a person is within operating distance, which will make it light up in the dark. The Alarm Keypad 2 includes a tamper switch, making it ideal for security purposes.

Disclaimers

CAUTION:

- Choking hazard! Keep away from children. Contains small parts.
- Please follow the guidelines thoroughly. The Alarm Keypad 2 is a preventive, informing device, not a guarantee or insurance that sufficient warning or protection will be provided, or that no property damage, theft, injury, or any similar situation will take place. friend cannot be held responsible in case any of the above-mentioned situations occur.

Precautions

- Do not remove the product label as it contains important information.
- Be aware that electronics are sensitive to static electricity, so aim to discharge before touching, and avoid touching any components inside the device.
- Do not paint the device.

Placement

- Place the Alarm Keypad 2 indoors at 0-50 degrees °C.
- Place the device inside the premises supervised by the alarm system.
- Place the device, so it is easily accessible to users.
- Avoid placing the device in direct sunlight.
- Avoid placing the device in places exposed to direct rain.
- Avoid placing moving items 40 cm or less from the Alarm Keypad 2, as they will activate the presence sensor.

Getting started

- Open the casing of the device by removing the screw at the bottom of the device.

a.



- Use the included screws to mount the back plate of the device on the wall.

b.

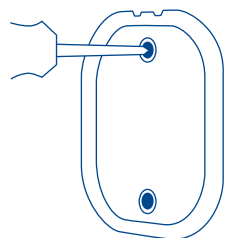

- Insert batteries into the device respecting the polarities.
- When the batteries are inserted, the Alarm Keypad 2 will start searching (up to 15 minutes) for a Zigbee network to join. While the keypad is searching for a Zigbee network to join, the yellow LED flashes.

c.

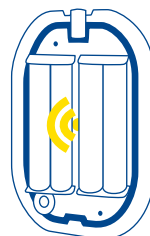

- If the scanning has timed out, a short press on the menu button inside the device will restart it.

- After connecting the device to a network, attach the device to the back plate by hooking the device to the top of the back plate and pushing the device against the back plate.

d.

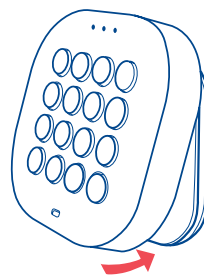

- Finally, reinsert the screw at the bottom of the device.

e.

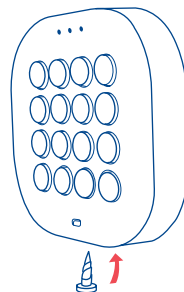

Resetting

Resetting is needed if you want to connect your Alarm Keypad 2 to another gateway or if you need to perform a factory reset to avoid abnormal behavior.

STEPS FOR RESETTING

- Open the casing of the device by removing the screw at the bottom of the device.
- Press and hold the menu button inside the device with a thin pin – e.g. a paper clip.

f.

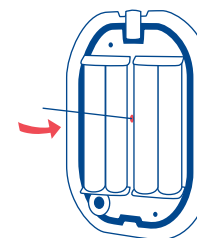

- While you are holding the button down, the LED first flashes once, then two times in a row, and finally numerous times in a row.
- Release the button while the LED is flashing numerous times in a row.
- After you release the button, the LED shows one long flash, and the reset is completed.

Battery replacement

When low battery is indicated replace the batteries.

CAUTION:

- Do not attempt to recharge or open the batteries.
- Risk of explosion if batteries are replaced by an incorrect type.
- Dispose of a battery into fire or a hot oven, or mechanically crushing or cutting of a battery can result in an explosion
- Leaving a battery in an extremely high temperature surrounding environment can result in an explosion or the leakage of flammable liquid or gas.
- A battery subjected to extremely low air pressure may result in an explosion or the leakage of flammable liquid or gas
- Maximum operation temperature is 50°C

- If you experience leakage from the batteries, immediately wash your hands and/or any affected area of your body thoroughly!

CAUTION: When removing cover for battery change - Electrostatic Discharge (ESD) can harm electronic components inside.

- To replace the batteries, remove the screw at the bottom of the device and open the casing.
- Replace all four batteries inside the device, respecting the polarities.
- Reattach the device to the backplate and reinsert the screw at the bottom of the device

Fault finding and cleaning

- In case of a bad or wireless weak signal, change the location of the device. Otherwise you can relocate your gateway or strengthen the signal with a range extender.
- If the search for a gateway has timed out, a short press on the button will restart it.

Functions

ACTIVATE

The keypad will activate automatically when a person approaches the front.

- The LEDs will indicate the system state.
- The keypad will return to idle mode after 5s if it is not activated.

ARM THE ALARM

The alarm can be armed in two ways:

- Enter a pin code and press   or 
- Hold a valid RFID tag in front of the center of the keypad and press   or 

The red LED will flash until the keypad is armed, then stay turned on.

If there is an error in arming the keypad, the yellow LED will flash 3 times and afterwards the green LED will turn on.

DISARM THE ALARM

The alarm can be disarmed in two ways:

- Enter a pin code and press 
- Hold a valid RFID tag in front of the center of the keypad and press 

If there is an error in disarming the keypad, the yellow LED will flash 3 times and afterwards, the red LED will turn on.
g.

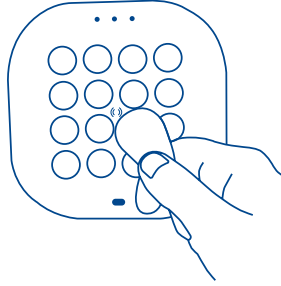

FAULTS (YELLOW LED FLASHING)

- Clear faults by one of the following methods:
1. Check the mobile app. (Faults are indicated in the app)
 2. Enter pin + (Clear Alarm log)
- If the faults cannot be cleared in these ways, consult the mobile app for details.

- Arming is forced (overrules blocked arming) by:
- Entering a pin code and pressing long on , or .
 - Pressing 3 times fast within 5 seconds after failed arming attempt.

SYMBOL	FUNCTION
	Arm all zones
	Disarm
	Arm day/home zones only
	Arm night/sleep zones only
SOS	Emergency - press button for 3 seconds
X	Clear all inputs
0 to 9	Input to arm/disarm code

LEDs

LED	FUNCTION
Red (LED1)	Armed (solid) Arm delay (flashing)
Yellow (LED2)	Faults (solid) Not ready to arm (flashing)
Green (LED3)	Disarmed (solid) Disarm delay (flashing)

h.

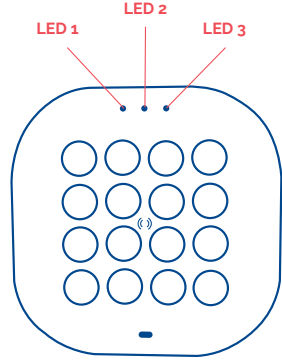

Disposal

Dispose the product and batteries properly at the end of their lives. This is electronic waste which should be recycled.

CE certification

The CE mark affixed to this product confirms its compliance with the European Directives which apply to the product and, in particular, its compliance with the harmonized standards and specifications.



IN ACCORDANCE WITH THE DIRECTIVES

- Radio Equipment Directive (RED) 2014/53/EU
- RoHS Directive 2015/863/EU amending 2011/65/EU
- REACH 1907/2006/EU + 2016/1688

Technical specifications

- General:
- Dimensions: 90 x 90 x 22 mm
 - Weight without batteries: 92.3 g (with batteries + packaging 241.2 g)
- Power supply:
- Battery: 4 x AA Alkaline
 - Exchangeable (PS type C)
 - Battery life: 2 years (typical)
 - Low battery warning: 4.2 V
 - Minimum battery capacity: 2400 mAh
 - Power consumption in alarm stage: 110 uA
 - Power consumption outside of alarm stage: 100 uA
- Environment:
- For indoor use
 - Operating temperature: 0 – 50°C
 - Relative humidity 5% - 85% non-condensing

- Interconnection with gateway:
- via Zigbee 3.0
 - Zigbee frequency: 2.4 GHZ
 - Setting of pin & tag: follow instructions on the mobile app
- Serviceable parts:
- Battery: 4 x AA Alkaline

Other certifications



- Alarm Certified, Grade 2, Class II, internal, Type C
- EN 50131-1:2006+A3:2020
 - EN 50131-3:2009
 - EN 50131-5-3:2017

- EN 50130-4:2011+A1:2014
 - EN 50130-5:2011
 - EN 50131-6:2017+A1:2021
- Certified by Kiwa Nederlands B.V

All rights reserved.

frient assumes no responsibility for any errors, which may appear in this manual. Furthermore, frient reserves the right to alter the hardware, software, and/or specifications detailed herein at any time without notice, and frient does not make any commitment to update the information contained herein. All the trademarks listed herein are owned by their respective owners.

Distributed by frient A/S
Tangen 27
8200 Aarhus
Denmark
www.frient.com
Copyright © frient A/S

